

FARRIS, HANSEN & ASSOCIATES, INC.

ENGINEERING — ARCHITECTURE — SURVEYING
7 RIDGWAY COURT — P.O. BOX 437 — ELKHORN, WISCONSIN 53121
PHONE: (262) 723-2098 FAX: (262) 723-5886

PLAT OF SURVEY

LOT 53 OF OAK KNOLLS OF WALWORTH ADD. NO. 1
LOCATED IN PART OF THE SE 1/4 OF SECTION 22,
TOWN 1 NORTH, RANGE 16 EAST, VILLAGE OF WALWORTH
WALWORTH COUNTY, WISCONSIN

— WORK ORDERED BY —
ROBERT & TINA HOUIS
P.O. BOX 159
WALWORTH, WI 53184

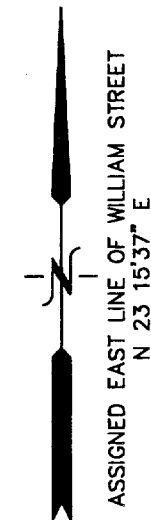

NOTE: EASEMENT REFERENCED IN TITLE
AS DOC. 327730 DESCRIBES A UTILITY
EASEMENT AFFECTING ONLY LOT 69
OF OAK KNOLLS ADDITION 1.

LEGEND
● = FOUND IRON REBAR STAKE
(XXX) = RECORDED AS

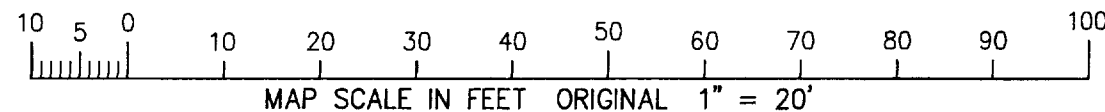

NOTE: COPIES OF THIS MAP TO WHICH THE FOLLOWING CERTIFICATE WILL APPLY SHOW THE SURVEYOR'S ORIGINAL SEAL AND SIGNATURE IN RED INK. COPIES BY ANY OTHER MEANS MAY HAVE ALTERATIONS WHICH DO NOT REPRESENT THE SURVEYOR'S WORK PRODUCT.

I HEREBY CERTIFY THAT THE ABOVE DESCRIBED PROPERTY HAS BEEN SURVEYED UNDER MY DIRECTION AND THAT THE ABOVE MAP IS A TRUE REPRESENTATION THEREOF AND SHOWS THE SIZE AND LOCATION OF THE PROPERTY, ITS EXTERIOR BOUNDARIES, THE LOCATION OF ALL VISIBLE STRUCTURES, AND DIMENSIONS OF ALL PRINCIPLE BUILDINGS THEREON, BOUNDARY FENCES, APPARENT EASEMENTS, ROADWAYS, AND VISIBLE ENCROACHMENTS, IF ANY. THIS SURVEY IS MADE FOR THE USE OF THE PRESENT OWNERS OF THE PROPERTY, AND ALSO THOSE WHO PURCHASE, MORTGAGE, OR GUARANTEE THE TITLE THERETO WITHIN ONE YEAR FROM THE DATE HEREOF.

DATED: JULY 16, 2004

PETER S. GORDON

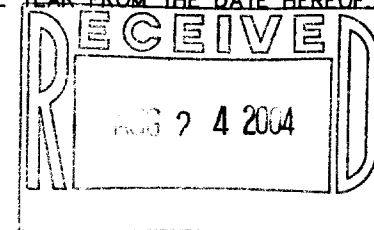

JUL 24 2004

PROJECT: 6604
DATE: 07/16/2004
SHEET 1 OF 1

VOKI 00026

X:\Projects\6604\Doc\SURVEY 7/16/2004

009-931